

INSTRUCTIONS

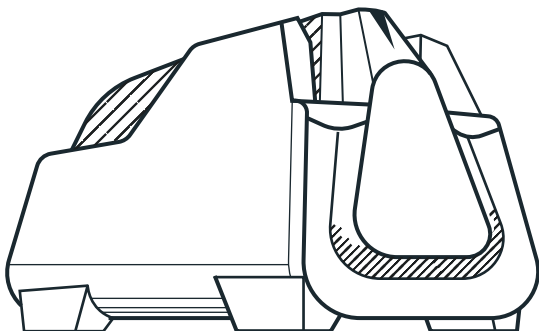

KITCHEN KNIFE SHARPENER

CPE2

For instructional videos visit:
WORKSHARPTOOLS.COM



SHARPEN YOUR SKILLS IN
— THE —
WORKSHOP
[YOUTUBE.COM/WORKSHARPOUTDOOR](https://www.youtube.com/worksharpoutdoor)

Visit worksharptools.com and drilldoctor.com to view our lines of sharpeners!

KNIVES

Connect the sharpener to power. The power cord is located under the sharpener.

SHARPEN

Press power button.

Insert the heel of the knife into either sharpening slot, resting the knife on the edge guide towards the center of the machine.

Slowly pull knife through, from heel to tip.

KNIFE AGAINST GUIDE
IN SHARPENING SLOT

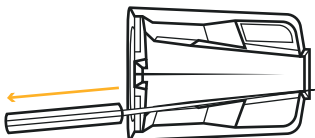
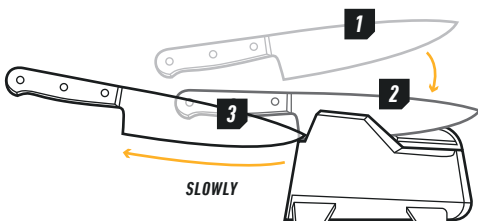
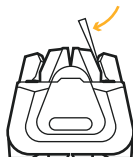

Repeat on the opposite side. Continue alternating sides until machine turns off.



The sharpener will automatically decrease in speed as it completes the cycle.

Test knife for sharpness by slicing paper or a tomato. If the knife slices well, proceed to **HONE**. If not, repeat the **SHARPEN** step.

PRO TIP: Dull knives may require multiple sharpening cycles for the desired results.

HONE

Hone your knife after sharpening for best results.

To hone your knife, insert the heel of the knife into the center honing slot.

With gentle downward pressure, slide your knife through back and forth along the full length of the blade 10 times.

KNIFE IN
HONING SLOT

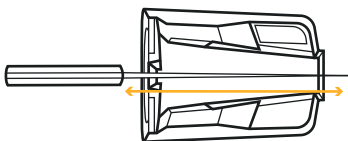
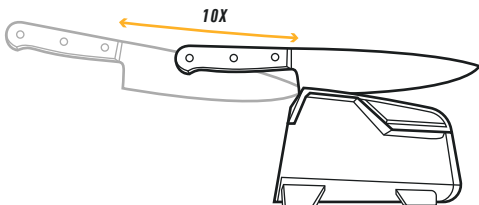
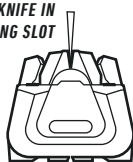

PRO TIP: For maintenance, use honing slot for weekly touch-ups.

ABRASIVES & MAINTENANCE

ABRASIVES

The Kitchen Knife Sharpener Abrasive Discs are reversible and replaceable for maximum sharpenings. To change or reverse, remove the guide and open top cover. Remove o-ring and unscrew fastener holding abrasive in place.

Replacement discs can be found at worksharptools.com.

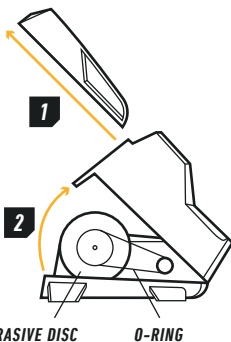

CLEANING

After each use, unplug your machine and wipe the inside and outside of your sharpener with a dry cloth to remove any grinding dust that may have accumulated while sharpening.

SCISSORS

Remove the guide by sliding forward and off.

Place the scissor blade, beveled edge down, all the way to the hinge and rest on the guide.

Press power button.

Slowly pull blade straight along from hinge to tip. Repeat 2-5 times.

Repeat the same number of strokes on other beveled side.

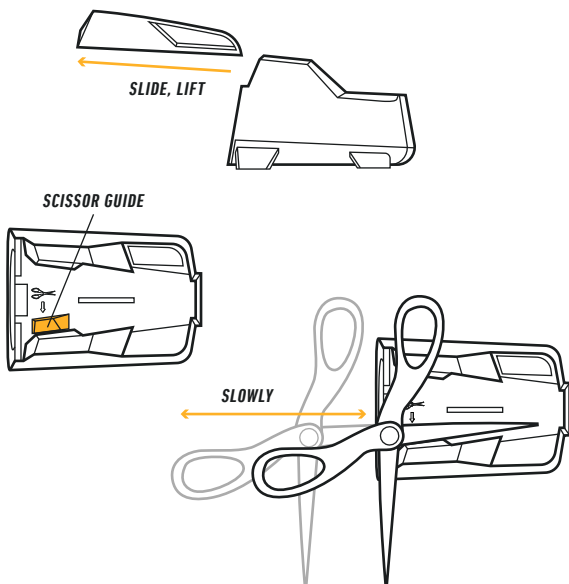

SERRATED KNIVES

Only use the honing slot for serrated knives. With gentle downward pressure, slide the knife back and forth along the full length of the blade 10 times.

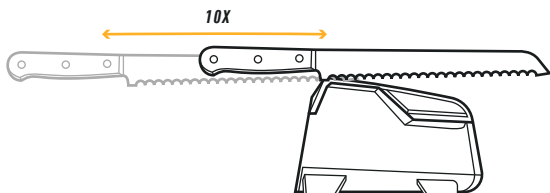
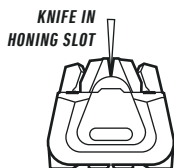

SAFETY

IMPORTANT SAFEGUARDS

⚠ WARNING! Read all safety warnings and all instructions. When using electrical appliances, basic safety precautions should always be followed. Every user should read these instructions.

⚠ WARNING! You will be creating incredibly sharp knives and tools with this sharpener. Please handle them with care. Use caution to avoid cutting yourself.

After each use, wipe the inside & outside of your sharpener with a dry cloth to remove any grinding dust that may have accumulated.

FOR HOUSEHOLD USE ONLY

Close supervision is necessary when any appliance is used by or near children.

Children should not play with appliance.

Do not let the power cord hang over edge of table or counter.

The appliance is only to be used with the power supply unit provided with the appliance. It must be supplied at safety extra low voltage corresponding to the marking on the appliance.

Do not abuse the cord. Never use the cord for carrying, pulling or unplugging the appliance. Keep cord away from heat, oil, sharp edges and moving parts. Damaged or entangled cords increase the risk of electric shock.

Carefully route the power cord to avoid damage from the knife blades while sharpening.

Do not use appliance with a damaged cord or plug or after the appliance malfunctions or is dropped or damaged in any manner. Return appliance to the nearest qualified service center for examination, repair or electrical or mechanical adjustment. (Type X attachment).

Turn off and unplug from outlet when not in use, before putting on or taking off parts, and before cleaning.

Stay alert. This appliance is not to be used by persons (including children) with reduced physical, sensory or mental capabilities, or lack of experience and knowledge, unless they have been given supervision or instruction.

To protect against electrical hazards, do not immerse in water or other liquid. Do not expose to rain or wet conditions.

Avoid contact with moving parts.

Only use replacement parts or attachments recommended or sold by the manufacturer. Use of unauthorized parts may cause fire, electric shock or injury.

Only insert clean knife blades into the appliance. Do not attempt to sharpen axes or other tools, or any blade that does not fit properly into the sharpening slots.

Do not use oils, water or any other lubricant with appliance.

Do not operate appliance if the switch does not turn it on and off.

Do not use outdoors.

SAVE THESE INSTRUCTIONS - Original Instructions

SERVICE

Please contact Work Sharp Customer Support:

worksharptools.com

1.800.418.1439

info@worksharptools.com

WORK SHARP

P.O. Box 730

210 East Hersey St.

Ashland, OR 97520 USA

WARRANTY

This sharpener is covered by Work Sharp's 3-year warranty. We stand behind and support our products – contact us if you need assistance, parts, or service. Warranty for consumer not industrial or commercial use, excludes abrasives.



Register Online At:

www.worksharptools.com

*Excludes Abrasives

**PLEASE LEAVE A REVIEW WHERE
YOU PURCHASED YOUR PRODUCT**



Work Sharp® is a registered trademark of Darex, LLC

For Patent Info Visit: worksharptools.com/patents

Designed in Ashland, OR. Made in China
